



**27 th World Championship for
Young Roofers**

Riga 2018

PITCHED ROOF

Task 1

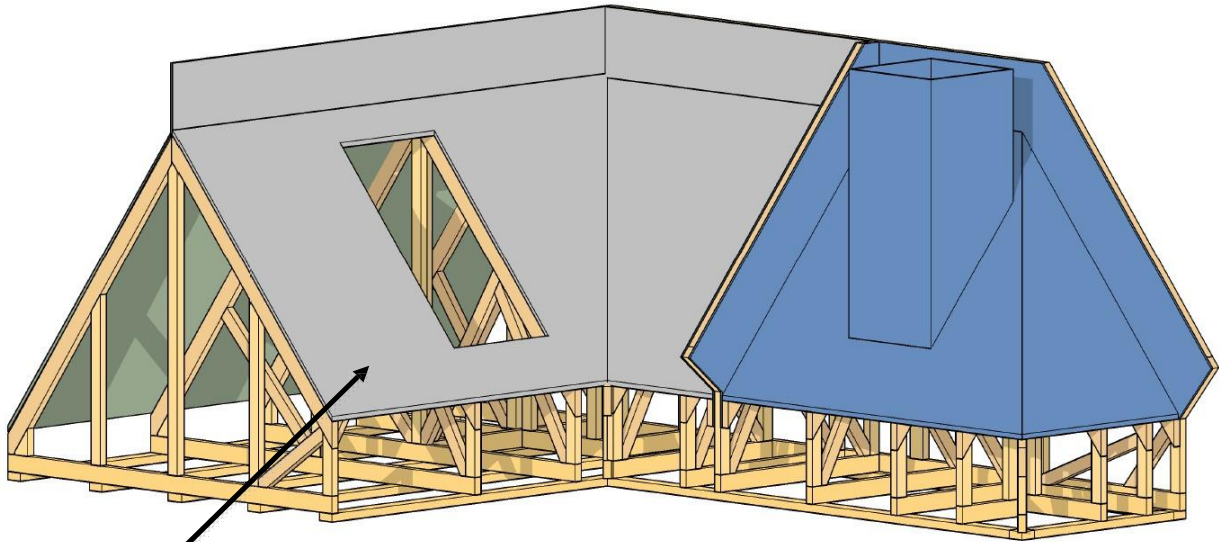

Day 1

- Mounted metal drip edge to the eave
- Vapour permeable membrane is placed parallel to the eave and stick to drip edge and walls.
- Ventilation battens mounted on rafters
- Battens mounted on roof model, observing tile clay step
- Rafter hooks and gutter with all accessories mounted on eave
- Roof window is mounted over the first row of tiles
- Roof valley mounted in place
- Mounted flashing to the side wall and seal it
- Roof tile laying on battens
- The left edge of the slope area is finished with edge-mounted tiles
- Fasten flashing and sealing it on the front wall

Task 2

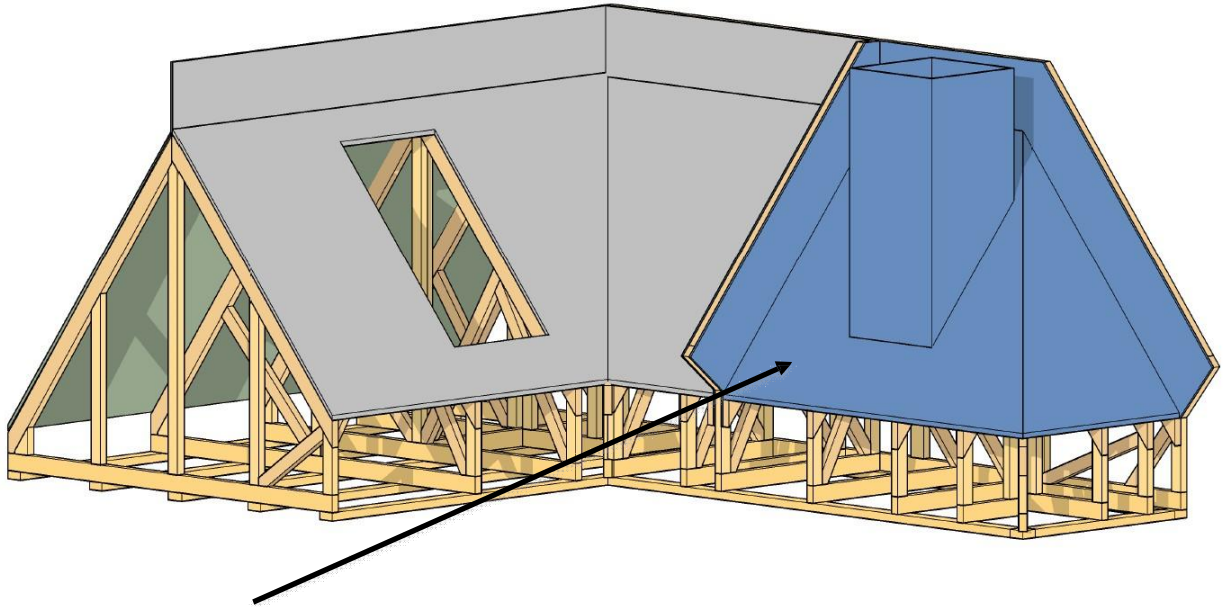

Day 2

- Mounted metal drip edge to the eave
- Vapour permeable membrane is placed parallel to the eave and stick to drip edge and walls.
- Ventilation battens mounted on rafters
- Battens mounted on roof model, observing tile clay step
- Rafter hooks and gutter with all accessories mounted on eave
- Mounting flashing to the side wall on both sides and sealing it
- Chimney flashing
- Roof tile laying on battens
- Ridge board and ridge tiles mounting on its place
- Fasten flashing and sealing it on the front wall

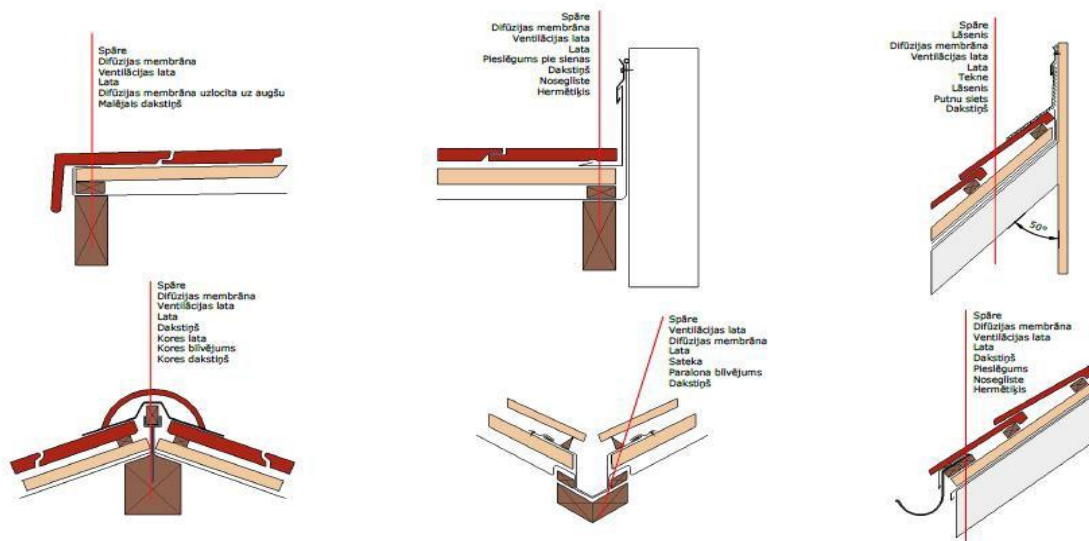

Freestyle

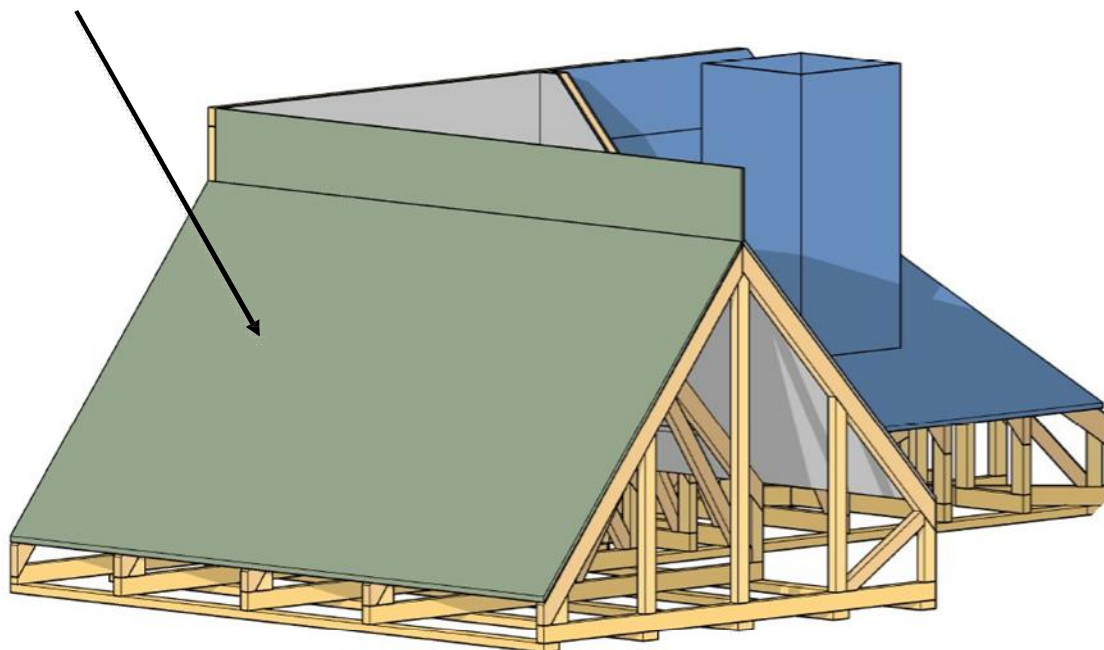

- Mounted metal drip edge to the eave
- Vapour permeable membrane is placed parallel to the eaves.
- Ventilation battens mounted on rafters
- Battens mounted on roof model
- Roof tile laying in freestyle

METAL ROOF

Task 1

- Rafter hooks and gutter with all accessories mounted on eave
- Vapour permeable membrane is placed parallel to the eave and stick to drip edge and walls.
- Mounted metal drip edge to the eave
- Mount roof window with connections
- Mount a double standing seam profile
- Fold double standing seam profile to the vertical and side wall
- Set the flashing to the side and the vertical wall and seal it.
- Set gable detail and lock it

Day 1

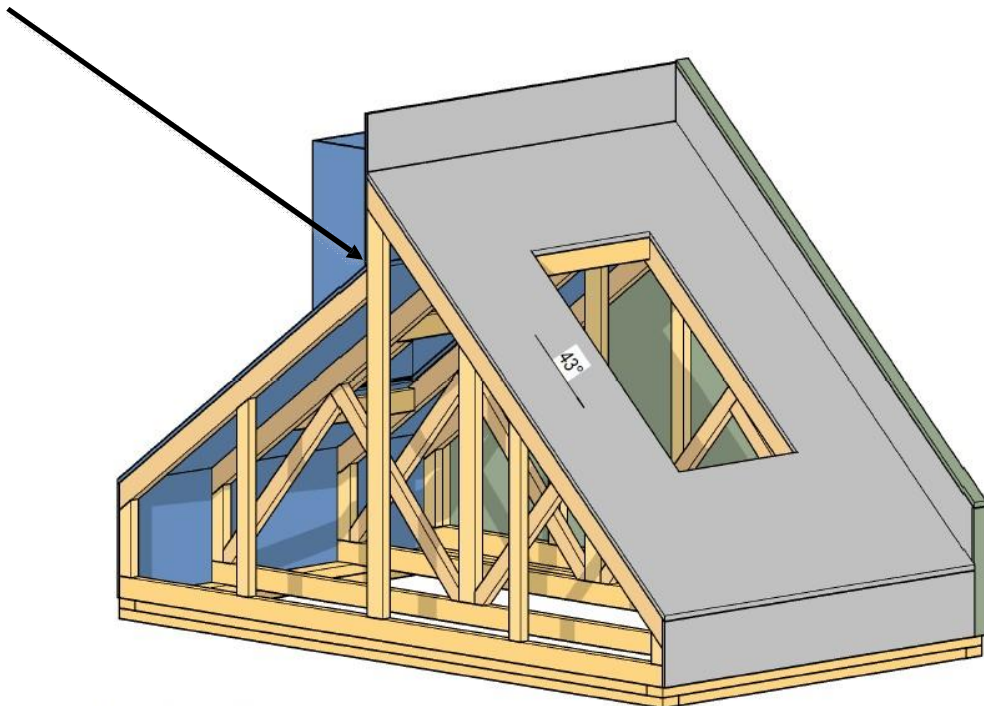

Task 2

- Mounted metal drip edge to the eave
- Vapour permeable membrane is placed parallel to the eave and stick to drip edge and walls.
- Mount a double standing seem profile
- Fold double standing seem profile to the vertical and side wall
- Mount flashing to the chimney and seal it
- Set the flashing to the side and the vertical wall and seal it.
- Set gable detail and lock it

Day 2

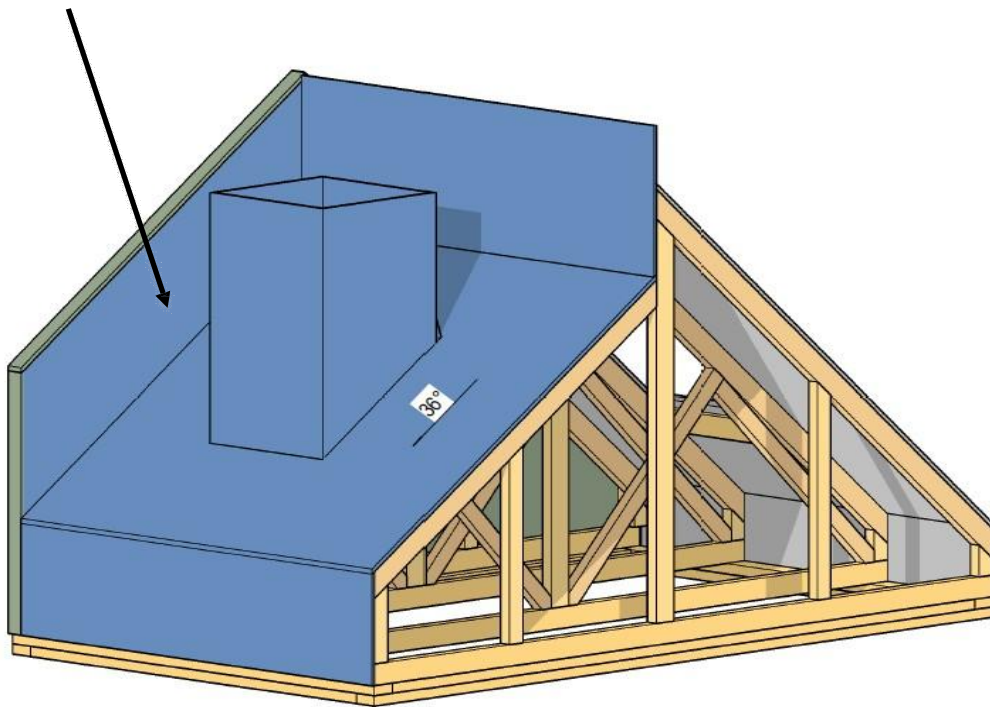

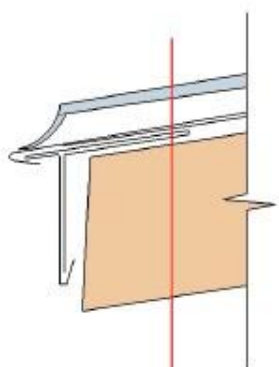

Cinkota profilēta metāla loksne
Zemsegums
Lāsenis
Alzabe 1 mm bieža
Koka klājs

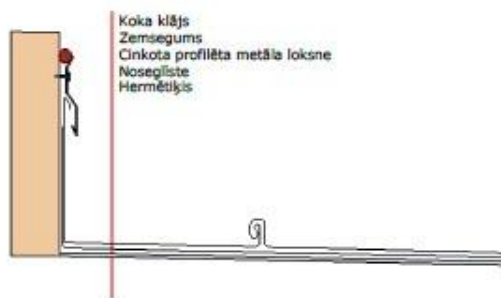

Koka klājs
Zemsegums
Cinkota profilēta metāla loksne
Noseglīste
Hermētīķis

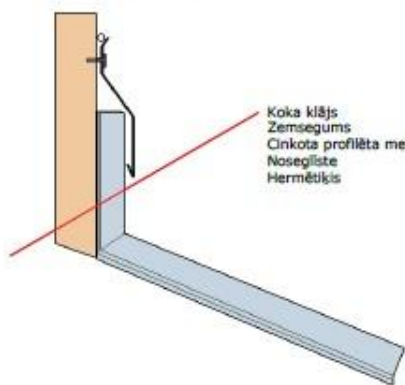

Koka klājs
Zemsegums
Cinkota profilēta metāla loksne
Noseglīste
Hermētīķis

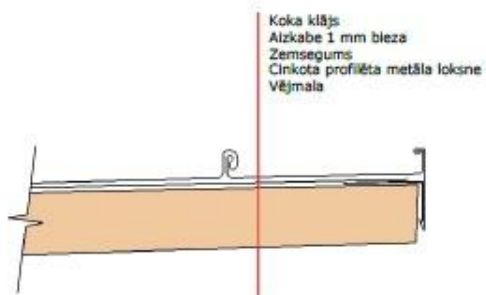

Koka klājs
Alzabe 1 mm bieža
Zemsegums
Cinkota profilēta metāla loksne
Vājmala

Freestyle

- The diffusion membrane is installed parallel to the bottom edge of the facade.
- A facade standing seem profile is for use.

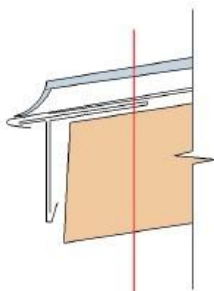
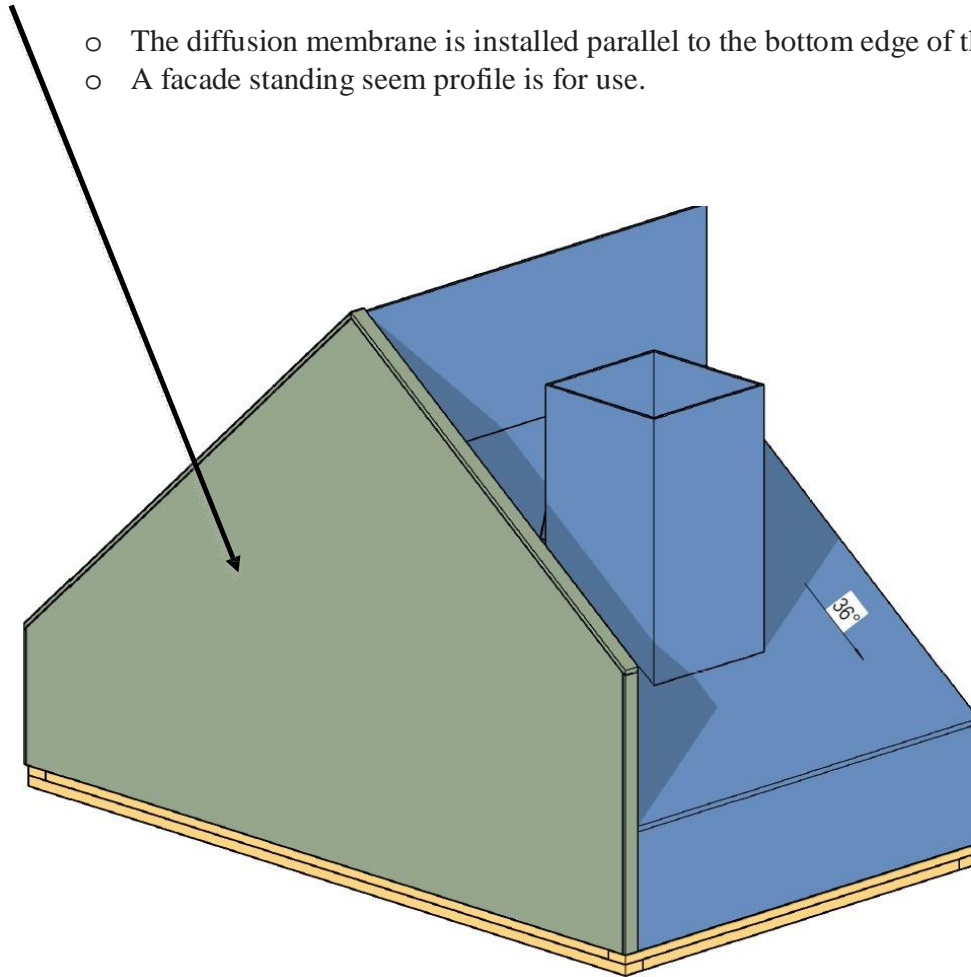

Cinkota profilēta metāla lokšne
Zemsegums
Līcenis
Alzkaibe 1 mm bieža
Koka klājs



Koka klājs
Zemsegums
Cinkota profilēta metāla lokšne
Noseglīste
Hermētiķis

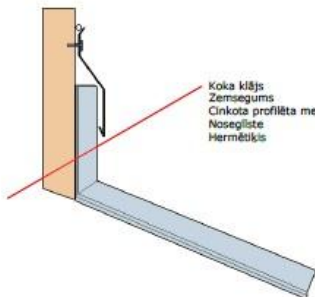

Koka klājs
Zemsegums
Cinkota profilēta metāla lokšne
Noseglīste
Hermētiķis

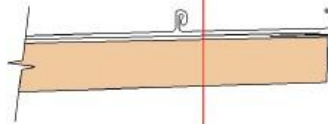

Koka klājs
Alzkaibe 1 mm bieža
Zemsegums
Cinkota profilēta metāla lokšne
Vējmaļa

FLAT ROOF

Task 1 PVC material

- Vapor permeable membrane glued fully up to the height of thermal insulation
- Insulation panels precisely cut, attached to each other and to the edge of the model
- Window installed on an extension frame mounted onto
- Separation sheet laid with overlaps of min.10 cm
- The membrane sheets are mechanically attached to the base.

Attic eaves covered with PVC and mechanically attached . Membrane off the slope (reinforced) heat-attached to the bar. The membrane protecting the side walls of the attic eaves (non-reinforced) heat attached at the bottom to the membrane covering the slope, glued to the side wall and heat-attached to the flashing of the outside edge of the wall covering. The inside edge of the wall and its upper surface are protected by a strip of separating layer. The metalwork for the wall covering is of sheet metal covered with PVC and attached to the base using screws.

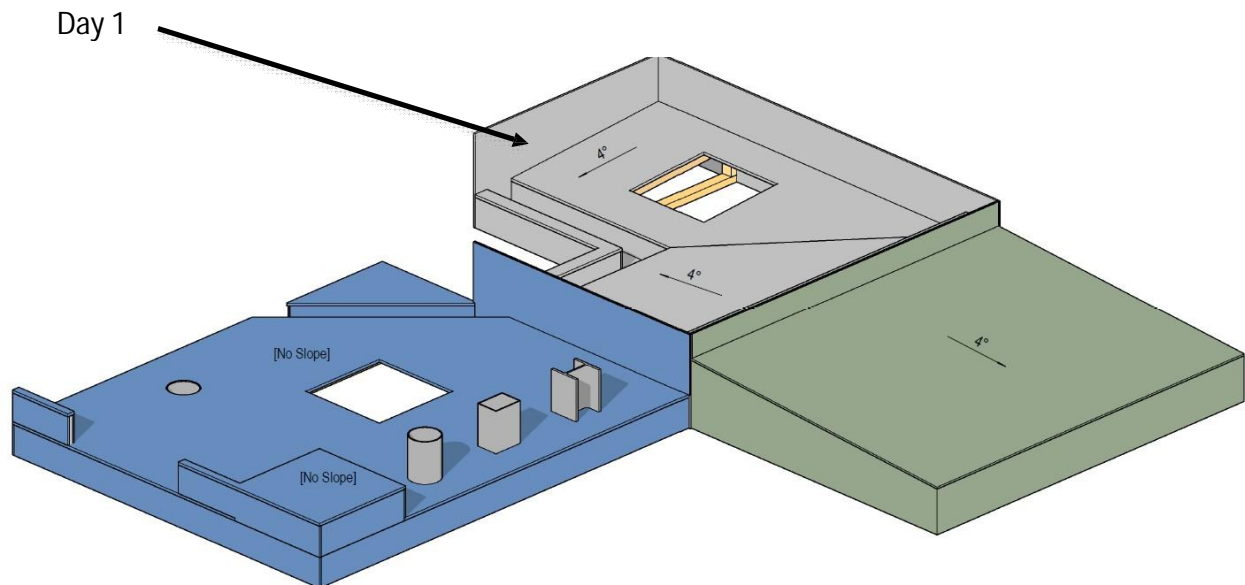

Task 2 ENKOPUR from ENKE

- Attach the fanlight to the base centered over the opening provided - screws no more than 30 cm apart.
 - Prime the surface using bituminous primer to which a base of self adhesive base paper will be glued (base, strip over the gutter and the lower fragment of the flashing of the fanlight), and Universal Primer 2K to the remaining surface, to which the liquid waterproofing will be applied.
 - Glue the self-adhesive base paper to the lower surface of the model.
 - Assign the surface to parts (threshold of the balcony window, landing, ventilation chimney, quadrangular post, H type support) and the surface of 2/3 of the model to be sealed up with liquid applied waterproofing - paper self-adhesive tape.
 - Cut the unwoven fabric for sealing an item in the model.
 - Seal the parts using the “liquid applied waterproofing” technology - Fanlight- ventilation chimney, landing, wall
 - Seal 2/3 of the surface of the model using the liquid applied waterproofing technology: layers (base, universal bituminous primer, self-adhesive base paper, Enkopur-P, Plyflexvlies non-woven fibre, Enkopur-P)
 - Height of the seal of the parts and the wall. Apply the liquid waterproofing beyond the upper edge of the unwoven fabric.
- Overlap of the unwoven fabric from the area designated for it onto the side surface of the part. Base paper strip overlaps.

Day 2

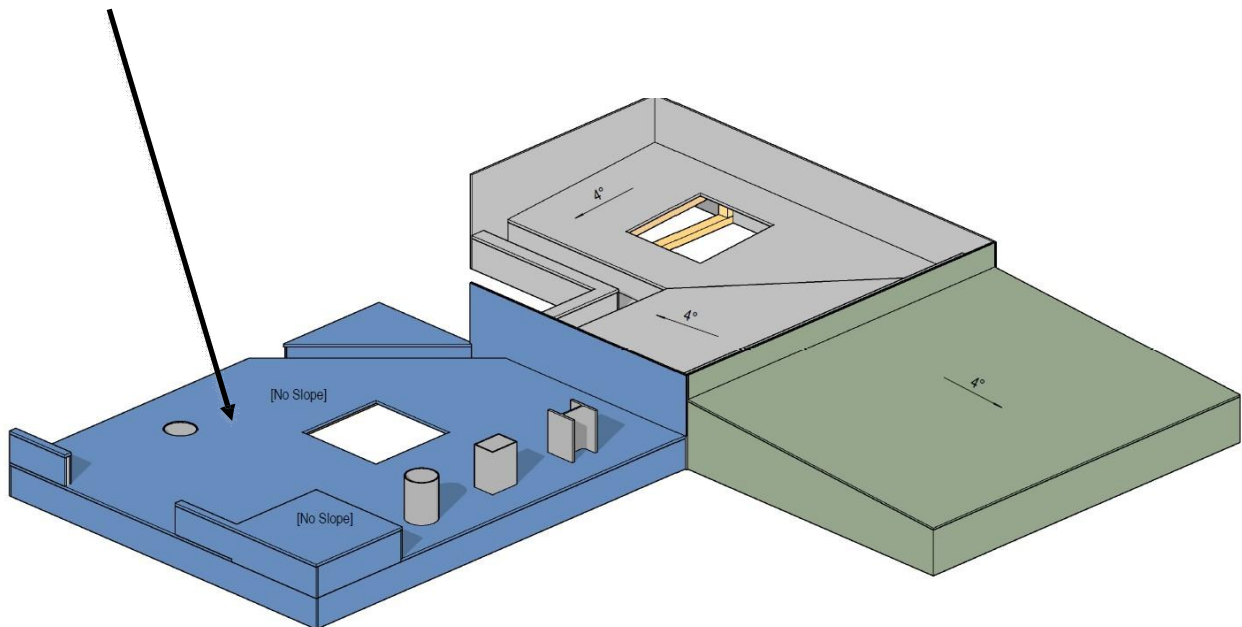

Freestyle

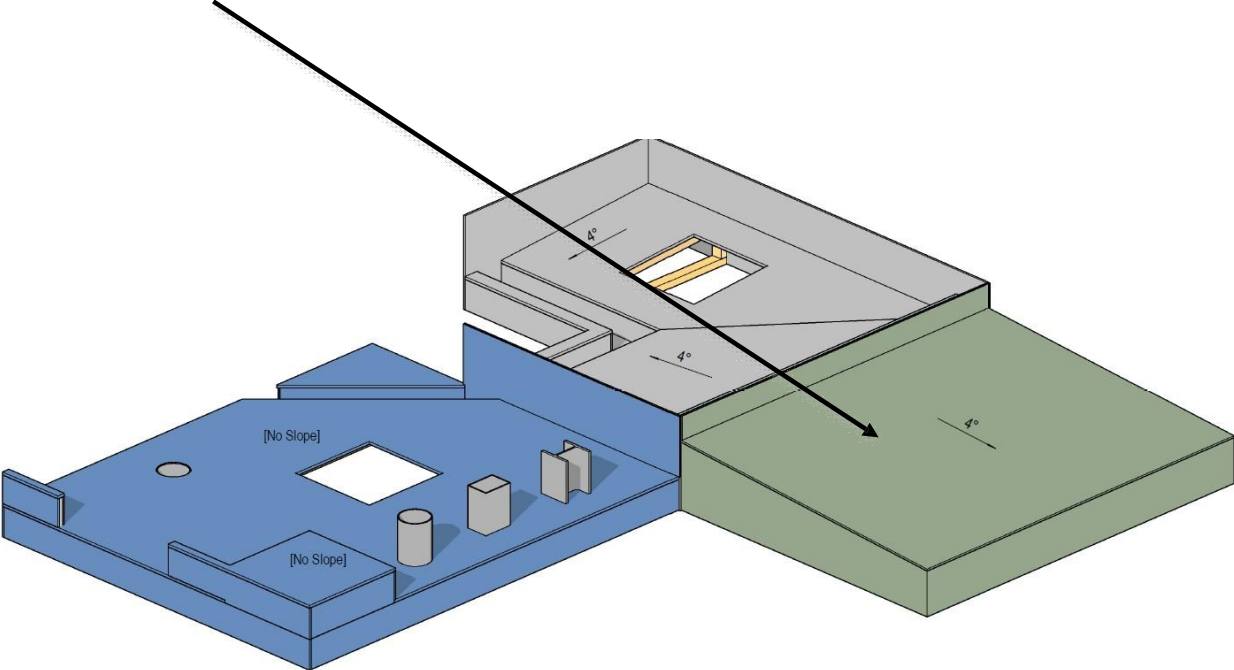

FACADE

Tasks

- Mounting wall brackets according to the facade cladding layout
- Mounting the cap profile
- Thermal insulation assembly
- Assembly of vertical AL profiles
- Assembling the sub-assembly of window frames
- Tin window sill mounting
- Mounting the cladding
- Made inside and outside corners

Day 1

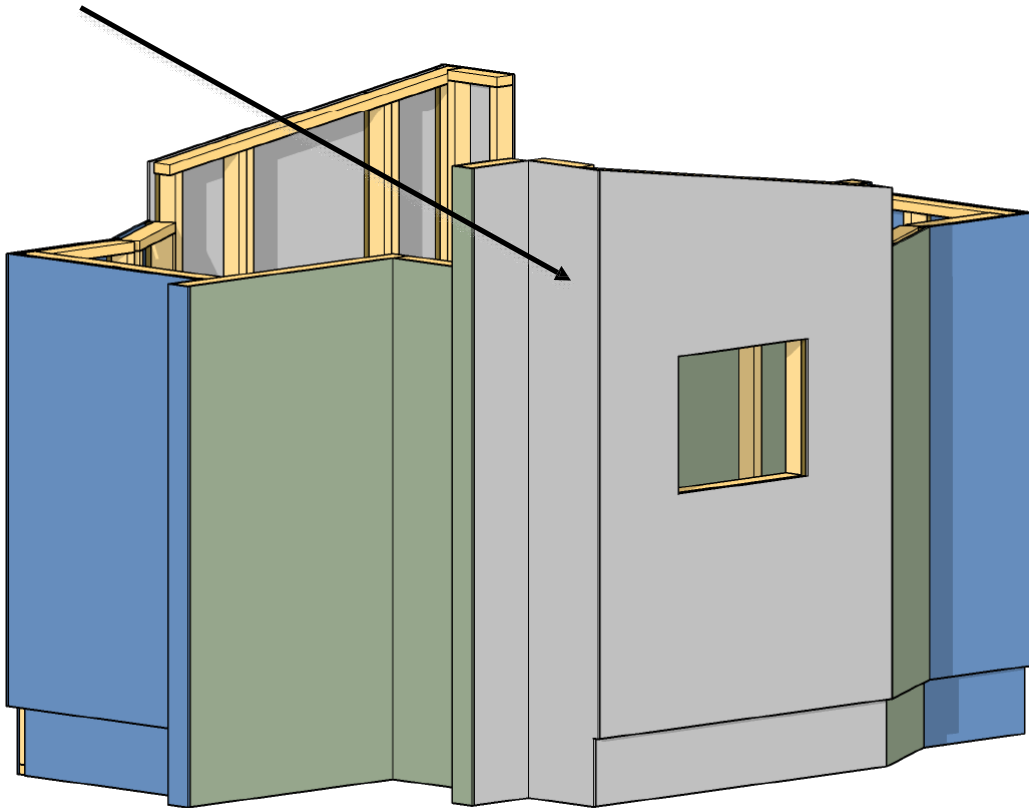

Tasks

- Mounting wall brackets according to the facade cladding layout
- Mounting the cap profile
- Thermal insulation assembly
- Mounting the cladding
- Made inside and outside comers

Day 2

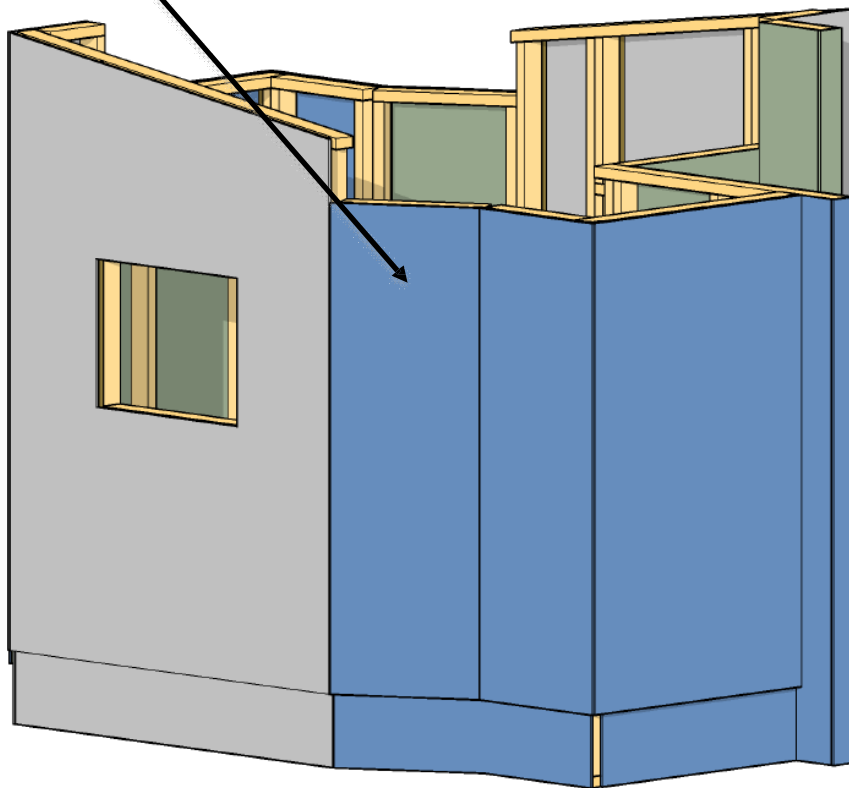

Tasks

- If possible cladding with natural slate???

Freestyle

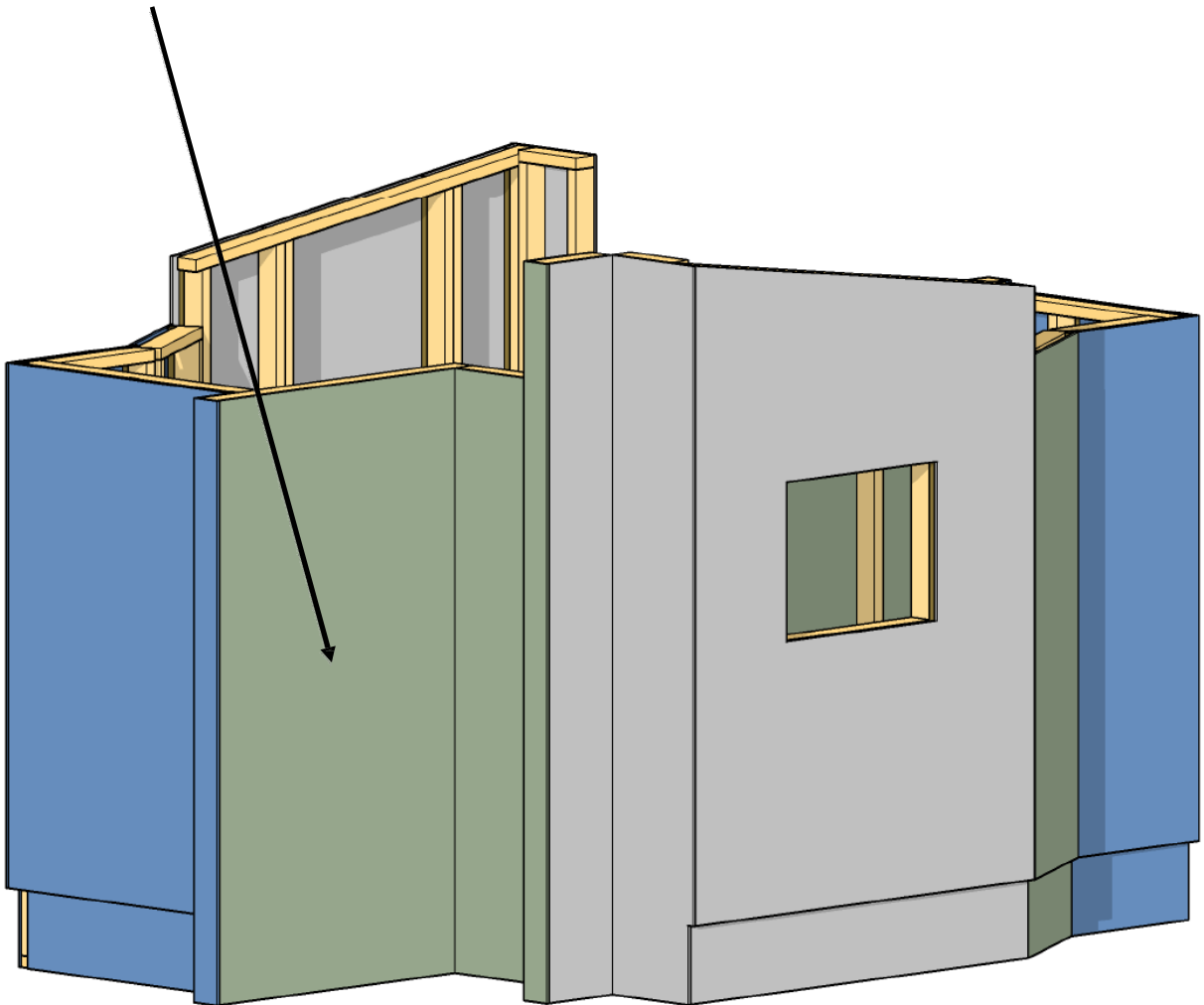

<p>Der 66. IFD KONGRESS und die 27. WELTMEISTERSCHAFT JUNGER DACHDECKER werden gemeinsam organisiert durch</p> <p>Internationale Föderation des Dachdeckerhandwerks e.V.</p> <p>Bahnhofstr. 27 a 35037 Marburg Deutschland</p>	<p>The 66th IFD CONGRESS and the 27th WORLD CHAMPIONSHIP FOR YOUNG ROOFERS are organized jointly by</p> <p>LATVIJAS JUMIĶU APVIENĪBA</p> <p>Būvniecības un izbūves arodu grupa Latvijas Amatniecības kameras profesionāla biedrība Lizuma iela 5i Rīga, LV-1006 Latvia</p>
<p>Durchführende Gesellschaft des 66. IFD Kongresses 2018 und der 27. Weltmeisterschaft Junger Dachdecker ist die Tochtergesellschaft der IFD, die</p>	<p>Executing company of the 66th IFD Congress 2018 and of the 27th world championship for Young Roofers is the daughter company of the IFD, the</p>
<p>IFD Service GmbH, Bahnhofstr. 27 a, 35037 Marburg, Germany</p>	

<p>Der 66. IFD Kongresses 2018 und die 27. Weltmeisterschaft Junger Dachdecker werden unterstützt von:</p>	<p>The 66th IFD Congress 2018 and of the 27th world championship for Young Roofers are supported by:</p>
--	--

